



BIKES

WWW.3GBIKES.COM

**OWNERS MANUAL
3G BEACH CRUISERS**

Owner's Manual for 3G Bikes

This manual contains important safety, performance and maintenance information. Read the manual and all warnings before taking your first ride on your new 3G Bikes and make sure to keep the manual handy for future reference.

Unsafe or improper use of any 3G Bikes by failing to read and comply with all safety, performance, maintenance requirements and warnings could result in serious injury or death. Assembly of your 3G Bikes by any party other than an authorized 3G Bikes dealer voids our manufacturer's warranty. It is strongly recommended to have all post-sale assembly and service work on your bicycle performed by a properly trained and equipped dealer.

When inspecting your bicycle, be certain to tighten all nuts and bolts properly. Under-tightening can result in loosening, parts loss and component damage. Over-tightened nuts and bolts can break. Certain parts have metric hardware -- always use the correct tools. If you have any questions or do not understand something, take responsibility for your safety and consult with your dealer or the bicycle's manufacturer.

This manual details general assembly and is not an in depth bicycle parts or function guide.

REGISTRATION

Your bicycle's serial number is stamped on the front of the head tube on top of the fork. Please record the serial number on your manual and make sure to register your bicycle online at: 3gbikes.com/bikeregistration/ Bicycles not registered on our database are not covered by our warranty. More on our warranty and serial in pages 13 & 14.

MODEL NAME: _____

SERIAL NUMBER: _____

COLOR: _____

DATE OF PURCHASE: _____

PLACE OF PURCHASE: _____

*We also recommend saving purchase invoices and receipts to better track your transactions.

Content

Pg.1	————	Introduction / Registration
Pg.2	————	Table of Contents
Pg.3	————	Identifying the Product
Pg.4	————	Identifying the Product Cont.
Pg.5	————	Assembly Overview
Pg.6	————	Frame Parts
Pg.7	————	Bicycle Sizing
Pg.8	————	Seat and Handlebar
Pg.9	————	Adjusting Seat
Pg.10	————	Adjusting Handlebar
Pg.11	————	Handlebar Components
Pg.12	————	Installing Pedals
Pg.13	————	Bottom Bracket
Pg.14	————	Three Piece Crank
Pg.15	————	Limited Warranty
Pg.16	————	Serial Number

Identifying the Product Model

At 3G Bikes we have over 20 different product models ranging from beach cruisers to specialty bicycles like tandems and tricycles. It is important to correctly identify which model you have in order to correctly assemble and maintain your bike. Some of the most obvious differences will be the frame material, crank set, wheel and stem style. Below is a quick model chart.

Steel Beach Cruisers

Model	Frame	Wheel / Tire	Speeds	Crank Set
Axel - Boy's	Steel	20"x1.75" / 20"x3.45" Twenty-G	1spd	1pc
Axel BBW - Boy's	Steel	20"x80mm / 20"x3.45" Twenty-G	1spd	3pc
Gigi - Girl's	Steel	20"x1.75" / 20"x3.45" Twenty-G	1spd	1pc
Gigi DLX- Girl's	Steel	20"x57mm / 20"x3.45" Twenty-G	1spd	1pc
Puck	Steel	24"x1.75" / 24"x3.45" Hoggy-G	1 spd	1pc
Puck DLX	Steel	24"x57mm / 24"x3.45" Hoggy-G	1spd	1pc
Roxie	Steel	24"x1.75" / 24"x3.45" Hoggy-G	1spd	1pc
Isla Vista	Steel	26"x1.75" / 26"x2.125"	Single Speed	1pc
Venice	Steel	26"x1.75" / 26"x2.125" Slicky-G	1, 3 & 7 spd	1pc (1, 3 spd) 3pc (7 spd)
Imperial BBW	Steel	26"x80mm / 26"x3.45" Boa-G	1 spd	3pc

Alloy Beach Cruisers

Newport	Aluminum	26"x1.75" / 26"x3.45" Boa-G	1, 3 & 7 spd	3pc
Newport DLX (Men's Only)	Aluminum	26"x57mm / 26"x3.45" Boa-G"	1 & 3 spd	3pc
Newport BBW	Aluminum	26"x80mm / 26"x3.45" Boa-G	1 & 8 spd	3pc



NOTE - Single speed beach cruisers feature coaster brake hubs.
NOTE - DLX models feature 57mm wide rims, BBW models feature 80mm wide rims.

Identifying the Product Model

City Comfort Models:

Model	Frame	Wheel / Tire	Speeds	Crank Set
Chicago (Men's Model)	Steel	700c / 29"x45"	1 & 7 spd	1pc (1 spd) 3pc (7 spd)
G'Bonita (Ladies' Model)	Steel	700c / 29"x45"	1 & 7 spd	1pc (1 spd) 3pc (7 spd)
Broadway (Men's Model)	Aluminum	700c / 29"x45"	1 & 7 spd	3pc
G'Linda (Ladies' Model)	Aluminum	700c / 29"x45"	1 & 7 spd	3pc

Specialty Models:

Model	Frame	Wheel / Tire	Speeds	Crank Set
Double Header (Tandem)	Aluminum	26"x1.75" / 26"x2.125" Slicky-G	1 spd	3 pc
Asbury (Tricycle)	Aluminum	front: 24"1.75" / Hoggy-G Rear: 20"x3.45" / Twenty-G	1 spd	3 pc
Asbury DLX (Tricycle)	Aluminum	front: 24"57mm / Hoggy-G Rear: 20"x57mm / Twenty-G	1 spd	3pc

Rental Models:

Model	Frame	Wheel / Tire	Speeds	Crank Set
EZ Over	Aluminum	26"x1.75" / 26"x2.125" Slicky-G	1 spd	1 pc
EZ Over Plus	Aluminum	26"x1.75" / 26"x3.45" Boa-G	1 spd	3 pc

Our multiple speed models might feature "V" brakes on the front and rear wheel, derailleurs or disc brakes. We strongly recommend all these components be checked and adjustment by a professional bicycle mechanic to ensure correct installation.



NOTE - All models that feature a 1 piece crank set require pedals with 1/2" thread sizing. Models that feature 3 piece crank require 9/16" thread size.

Assembly Overview

Tools required to assemble and adjust your 3G Bikes bicycle are not included .

Tools you might need:

1. Rubber Mallet
2. Allen Key Set (3, 6 in particular)
3. Metric Wrench Set (14, 15, 17 in particular)
4. Standard Wrench Set (3/4" in particular)
5. Adjustable Wrench
6. Standard Screwdriver
7. WD40 (or similar lubricating product)

Right out of the box our bicycles come partly assembled although not completely adjusted. Use this list as an assembly guide and go through each part making sure that everything is secured correctly and tightened.

1. Seatpost, Seatpost Clamp and Saddle.
2. Crank Set and Pedals.
3. Install fork.
4. Assemble and Install Rear Wheel.
5. Install Front Wheel
5. Install Chain
6. Install Handlebars.
7. Install Shifter, Levers and Grips.
8. Install cables (and breaks if external)
9. Install Pedals.
10. Posture Setup.
11. Safety Check.



CAUTION - Remember that you should always thread nuts, bolts and pedals on by hand at first to ensure they do not cross thread

Frame Parts

This diagram shows many of the major features on several of our cruiser style bicycles. Model pictured is a men's bicycle frame in single speed, ladies' models feature step-through frames which are distinguishable by a low top tube. Multiple speed models will vary slightly to accomodate grip shifters, brakes and sometimes a derailleur.

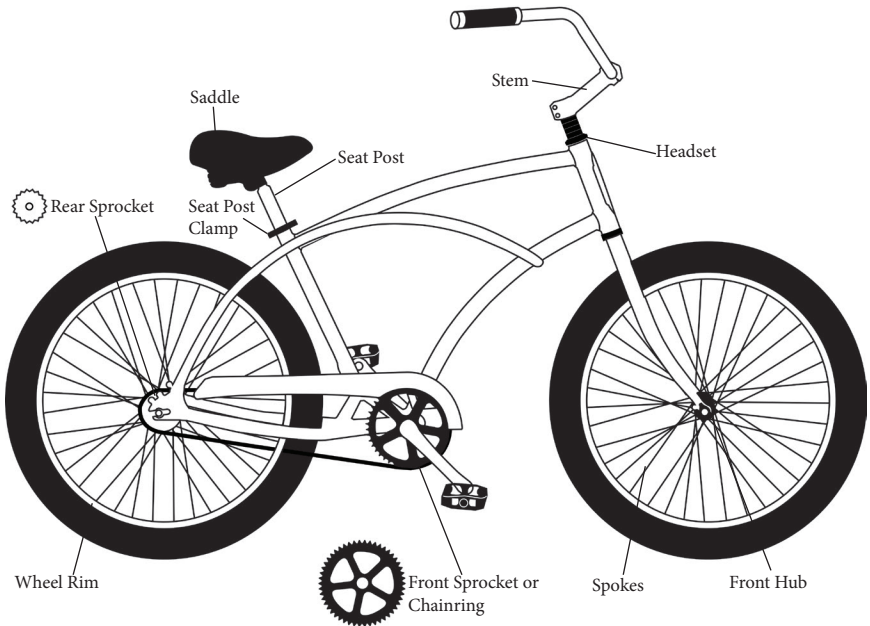

The Frame

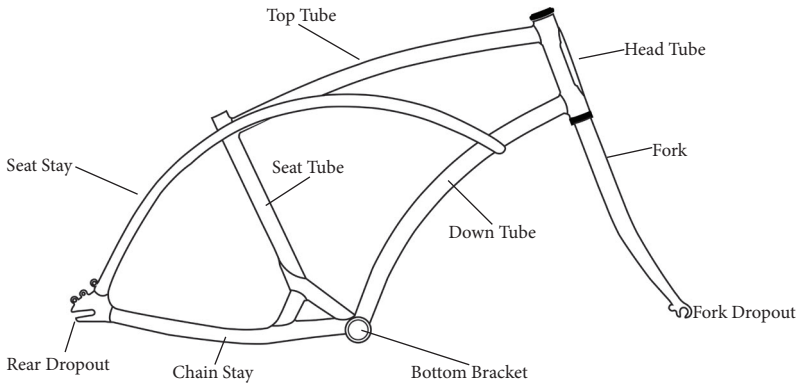

Bicycle Sizing

In order to benefit of the comfort focused design of 3G Bikes you must make sure that the bicycle you purchased provides the correct fit for you. Firstly you should be able to stand over the bicycle frame with both feet flat on the ground (see figure A).



Some of our bicycle models feature step-through frames which have a very low top tube.

Although not all of our bicycle models are available in different frame sizes, we do have a range of wheel sizes from 29", 26" and 24" for adults in order to meet different height requirements. Our city bikes come with 29" wheels and are available in a small and large frame size in all men's models.

Seat and Handlebar

The correct riding position for our bicycles will place your arms extended in front of your body and your legs comfortably stretched out when the pedal is at its furthest position (see figure B). If your feet can't reach the pedals when they are in the furthest position we suggest lowering the seat post a notch.



When setting the forward position of the handlebars, set them so that you can hold the handle-grips when your elbows are only slightly bent. You should have a strong grip and be able to easily turn the wheel in a 90° angle side to side.



NOTE - Seat posts have a minimum insertion mark that must be acknowledged, failure to do so can lead to the post bending or breaking.

WARNING - Do not place the seat tube all the way in so that the saddle touches the frame, doing so can result in the saddle being pushed off the seat tube and falling off.

Adjusting Seat

There are two type of seat post clamps we use in our bicycle models. Some are secured by allen bolts (see figure C) while others feature a quick release lever (see figure D).

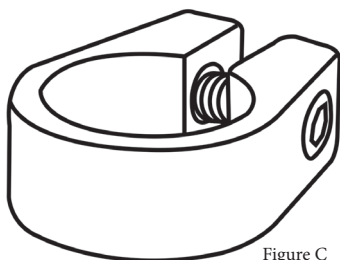

Figure C

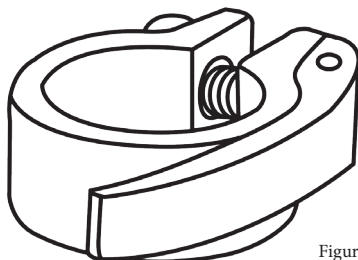

Figure D

Below you can see how to secure a quick release seat post clamp and adjust your bicycle seat.

1. First untighten the seat post clamp by flipping it outward and rotating it counterclockwise. Adjust the height of your seat. Noting the minimum insertion mark on your seat post.

2. Once the seat is at desired height, rotate the seat post clamp lever clockwise to tighten.

3. To secure the seat post flip the lever inwards making sure it is aligned to the clamp.

Step 1

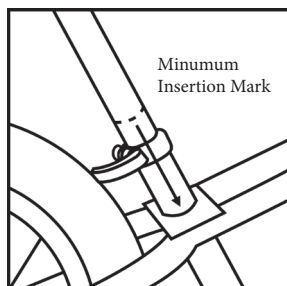

Step 2

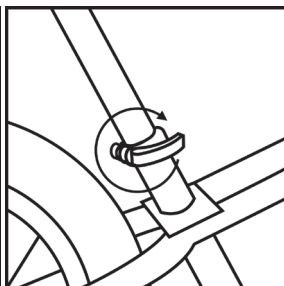

Step 3

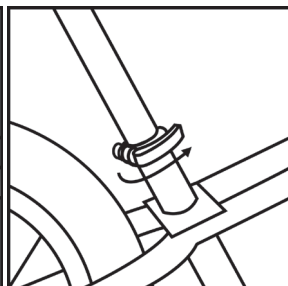

NOTE - Seat post clamp allen bolt usually require a 5mm hex key. It is important to make sure you are using the right sized tools in order to correctly adjust any part.

Adjusting Handlebar

All 3G models will feature one of two available styles of headsets and stem attachments, they will either be a ball bearing headset with a 1" HL quill stem for a threaded fork (see figure E) or a sealed headset with a thread-less 120mm Promax stem (see figure F).

Make sure that all components are installed in order presented. Some bicycle models require more or less spacers. If you have trouble adjusting any part of your fork and headset please contact your nearest 3G Bikes bicycle dealer with any questions.

Figure E

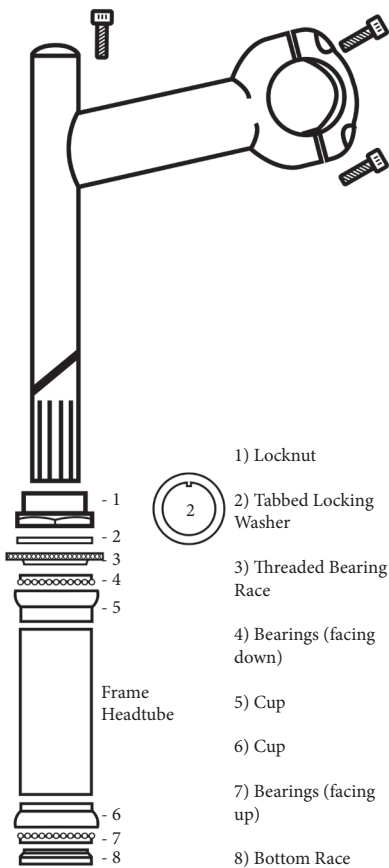
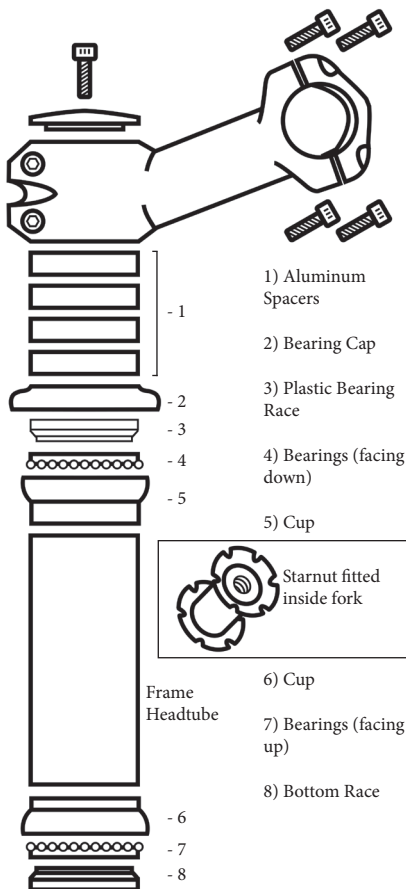
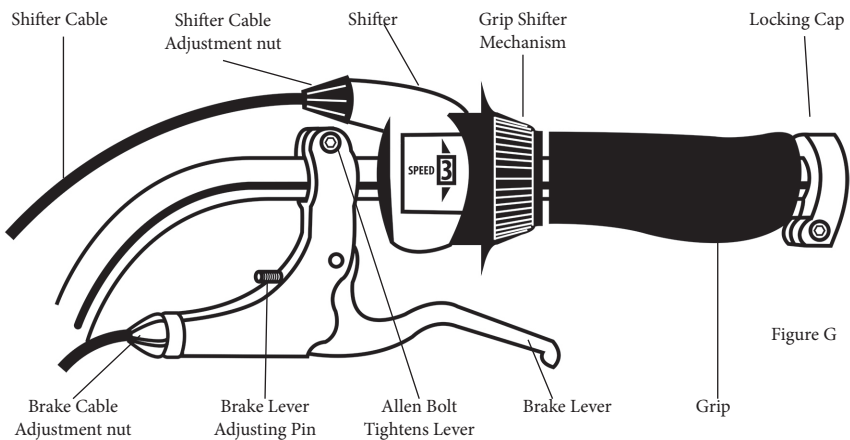

Figure F



Handlebar Components

The components on a 3G Bikes handlebar will vary depending on the speed and model of the bicycle. Single speed models do not feature brake levers or shifter parts. Not all multiple speed shifters look the same, but attachment on to handlebars will be similar. Below (see figure G) is a diagram showing the general assembly of handlebar components as seen on a three speed model.



Break and shifter cable routing might be internal or external depending on the model of bicycle. Please double check bicycle frame before considering converting a single speed model into a multiple speed.



NOTE - Specialty tools might be required for adjusting or installing shifter and break components. We always recommend having a licensed professional instal, adjust and repair any of the components on 3G Bicycles.

Installing Pedals

Before you put your pedals on the crank arms, be sure to take note which pedal is which. Each pedal is indicated by a letter stamped into the end of the pedal axle (see figure H).

When you have the correct pedal for the side you're on, thread the pedal on using just your hands at first. It should thread in fairly easily, otherwise you may be cross threading it which will strip the threads off the axle, ruining it. Using a wrench, tighten the pedal on fully.

Figure H

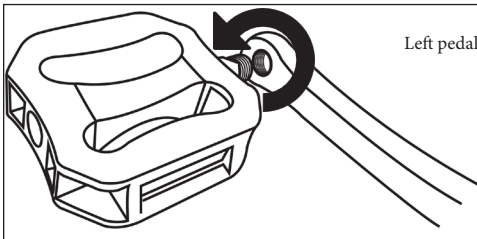
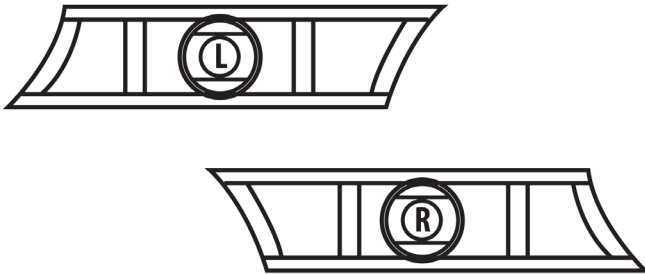

Left pedal tightens counter clockwise.

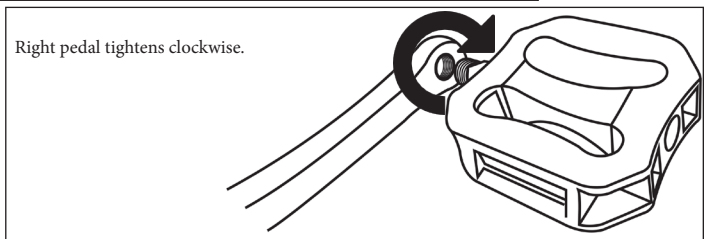

Right pedal tightens clockwise.

Bottom Bracket

Although the bottom bracket comes pre-installed on all our bicycles it is good to know how the general assembly of these components is in case of encountering problems (see figure I). Below is a diagram showcasing a one piece crank set, the parts involved will be slightly different on a three piece set.

Figure I

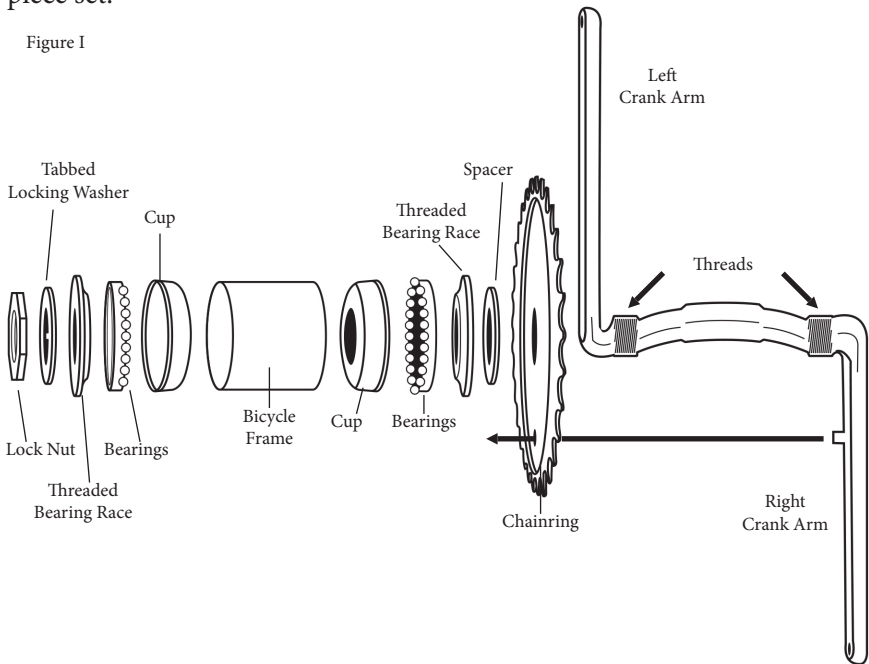

Installing Bottom Bracket

1. Feed left crank arm into hole in center of chainring.
2. Follow this with the plastic spacer and then the threaded race.
3. Grease the race and bearings, and feed the bearing onto the crank with balls facing in
4. Grease cups. Insert left crank arm through right side of bike.
5. Grease next set of bearings and feed them to the left arm facing inward.
6. Feed the second threaded race (flat side facing out).
7. Finish with the washer and a lock nut. Make sure whole assembly is tight but able to spin freely.



NOTE - The cups are the first parts to be installed into the frame. The threaded races thread onto the threads indicated on the crank itself. All pieces fit on via left crank arm (thinner arm)

Three Piece Crank

Some of our higher end bicycle models come with a three piece crank with a sealed bottom bracket (see figure J). It is called a three piece because it can be taken apart into three main components.

Figure J

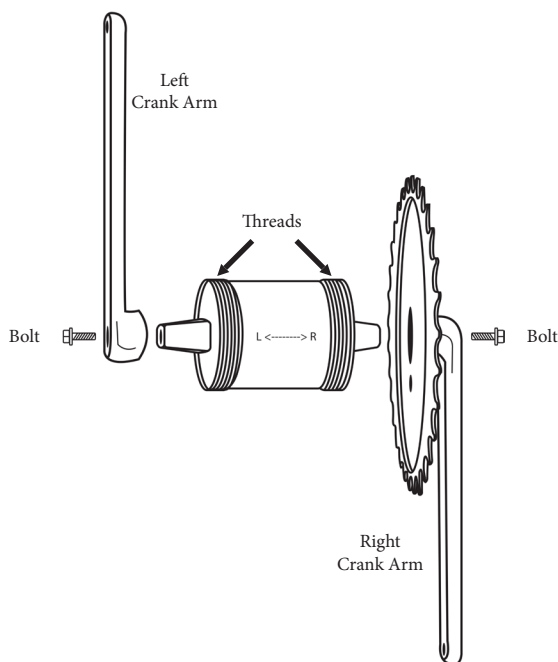

Please note that the threaded parts might require parts to be fed in different directions. Forcing parts onto the threads can result in damaging the parts.

Installing Three Piece Crank

1. Left side of the BB thread should be removable. Insert BB through right side and attach. Then insert loose thread through left and tighten.
2. Attach crank arms to BB and bolt in place.



NOTE - 3G Bikes always recommends having our products assembled, tuned and repaired by our authorized dealers. Improper assembly and damage will result in a voided warranty.

Limited Warranty

3G Bikes warrants the replacement of the components of 3G bicycles due to defects in material and/or workmanship. The following conditions and limitations apply:

1. Frames carry a limited lifetime replacement warranty for the original owner.
2. The components (not to include tires, tubes and cables) are warranted for one year.
3. Charges such as labor and transportation are not included.

This warranty is offered to the original retail purchase ONLY. Both proof of purchase from an authorized 3G Bikes dealer and warranty registration processed through the 3GBikes.com website are required to validate protection under this warranty.

Normal wear, accident, abuse, neglect, improper assembly, improper fit, or improper maintenance by anyone or the use of parts and devices not consistent with the use originally intended for the bicycle as sold are not covered under this limited warranty. The bending of frames, forks, handlebars, seat-post, fenders, chain-guards and rims is excluded from warranty. Bending is a sign of abuse or punishment inconsistent with bike's intended use, and therefore not covered under this limited warranty.

In order to validate your warranty it is necessary to have your bicycle assembled by an 3G Bikes dealer. Claims should be processed through an authorized dealer. This warranty is limited to replacing the defective part without charge and the company shall in no event be responsible for consequential or special damages. In the event that the bicycle has been used in stunt riding, ramp jumping, acrobatics or similar activities; this warranty is void. Likewise, the bicycle is not designed to be used with a motor.

This warranty is expressly in lieu of any other warranties. Any implied warranty, including any warranty of merchantability of fitness, shall be limited to the duration of the express warranty set forth herein. Warranty is void in its entirety by modifications to fork, frame or components.

In the event that a warranty claim for a defective part is approved, the part in question must be returned to our west coast headquarters in CA in order to receive any replacement part, 3G Bikes is not responsible for shipping charges.

Visit: 3gbikes.com/bikeregistration/ to register your bicycle.

Bicycle Serial Number

You may find your 3G Bikes bicycle serial number on the head tube of the frame towards the bottom. Please make sure to record this number for reference and register it online.



Weight Limits

Our bicycles come with 14 gauge spokes in either steel or stainless steel. A couple models will feature 12 gauge heavy duty spokes. This difference in gauge allows for the weight limit on our bicycles to vary a little bit.

14 gauge spokes can handle rider weights up to: 250lbs / 113kg

12 gauge spokes can handle rider weights up to: 350lbs / 158kg

Customer Resources

For more info on your product, please check the websites below:

www.3gbikes.com/contactus

www.3gbikes.com/support

www.3gbikes.com/warrantyclaim

www.3gbikes.com/findadealer

www.3gbikes.com/bikeregistration

EMAIL: SALES@3GBIKES.COM

WWW.3GBIKES.COM